

Rev	Date	Int	Notes
B	12-07-16	JW	Admin Update
A	23-10-13	GSH	First Issue
Project			
External Walk on Rooflight			
Title			
External Walk on Rooflight			
Scale	Date	Drawn By	Status
1:10 @ A3	23-10-13	GSH	OK
Contract No	VR-EW-01	Drawing No	Revision
			B

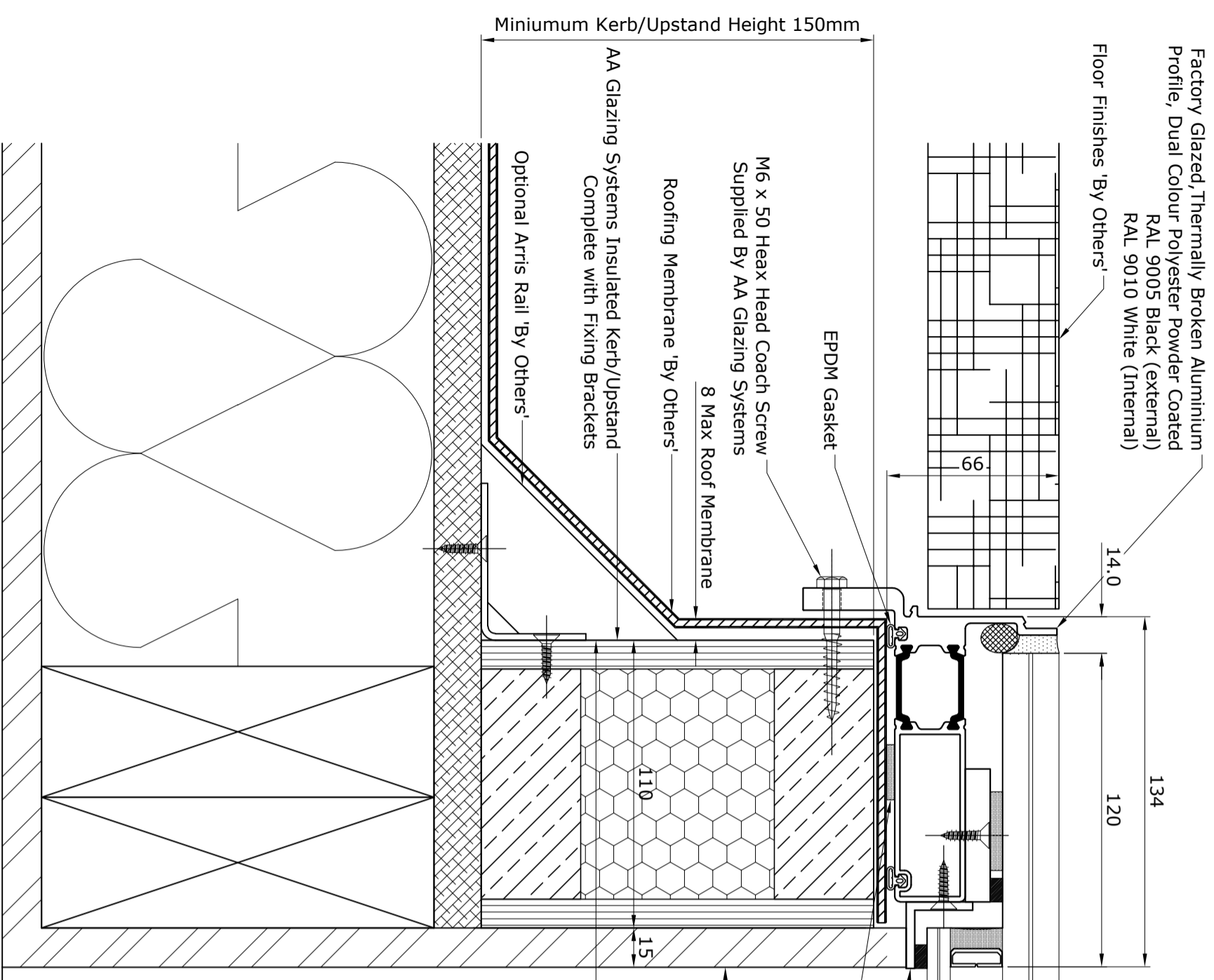

Registered Office: AA Glazing Systems Ltd, Unit Mill Lane,
Waterford Ind Est, Gt. Massingham, Norfolk, PE32 2HT
Tel: 01485-520860 Fax: 01485-520861
Email: sales@aa-glazing.co.uk
Registered in England and Wales company no. 4346652
VAT No. 792 777 488



Factory Glazed, Thermally Broken Aluminium Profile, Dual Colour Polyester Powder Coated
 RAL 9005 Black (external)
 RAL 9010 White (Internal)
 Floor Finishes 'By Others'

Minimum Kerb/Upstand Height 150mm
 AA Glazing Systems Insulated Kerb/Upstand Complete with Fixing Brackets
 Optional Arris Rail 'By Others'
 8 Max Roof Membrane
 Roofing Membrane 'By Others'
 EPDM Gasket
 M6 x 50 Hex Head Coach Screws Supplied By AA Glazing Systems

134
 14.0
 120

110
 15

Standard Walk-on DGU comprising of;
 21.5mm Clear toughened Laminate Outer with optional Solar Control Coating
 20mm Argon filled cavity with Black Warm Edge Spacer
 8.8mm Clear toughened Laminate Inner with Low E Coating

Aluminium Inner Pane Support Angle
 Polyester Powder Coated RAL 9010 White
 Apply 8mm Full perimeter Silicone Bead on Installation

Internal Finishes
 'By Others'
 (Standard)

'W' Width & 'H' Height Dimension
 Taken from External Upstand Size

Internal Finishes
 'By Others'
 (Optional)

Title			
Kerb / Upstand Section Details			
Scale	Date	Drawn By	Status
1:2 @ A3	23-10-13	GSH	
Contract No		VR-EWD-01	Revision
			B
Project	External Walk on Rooftight		
Rev	Date	Int	Notes
A	23-10-13	GSH	First Issue
B	12-07-16	JW	Admin Update



Registered Office: AA Glazing Systems Ltd, Unit 1 Mill Lane,
 Waterford Ind Est, Gt. Massingham, Norfolk, PE32 2HT
 Tel: 01485-520860 Fax: 01485-520861
 Email: sales@aa-glazing.co.uk
 Registered in England and Wales company no. 4346652
 VAT No. 792 777 488