

Project	Electric Lantern Opening Rooflight		
Title	Electric Lantern Opening Rooflight		
Scale	1:10 @ A3		
Contract No.			
Date	23-10-13		
Drawn By	GSH		
Status	Notes		
Rev	Date	Int	Notes
A	23-10-13	GSH	First Issue
B	12-07-16	JW	Admin Update

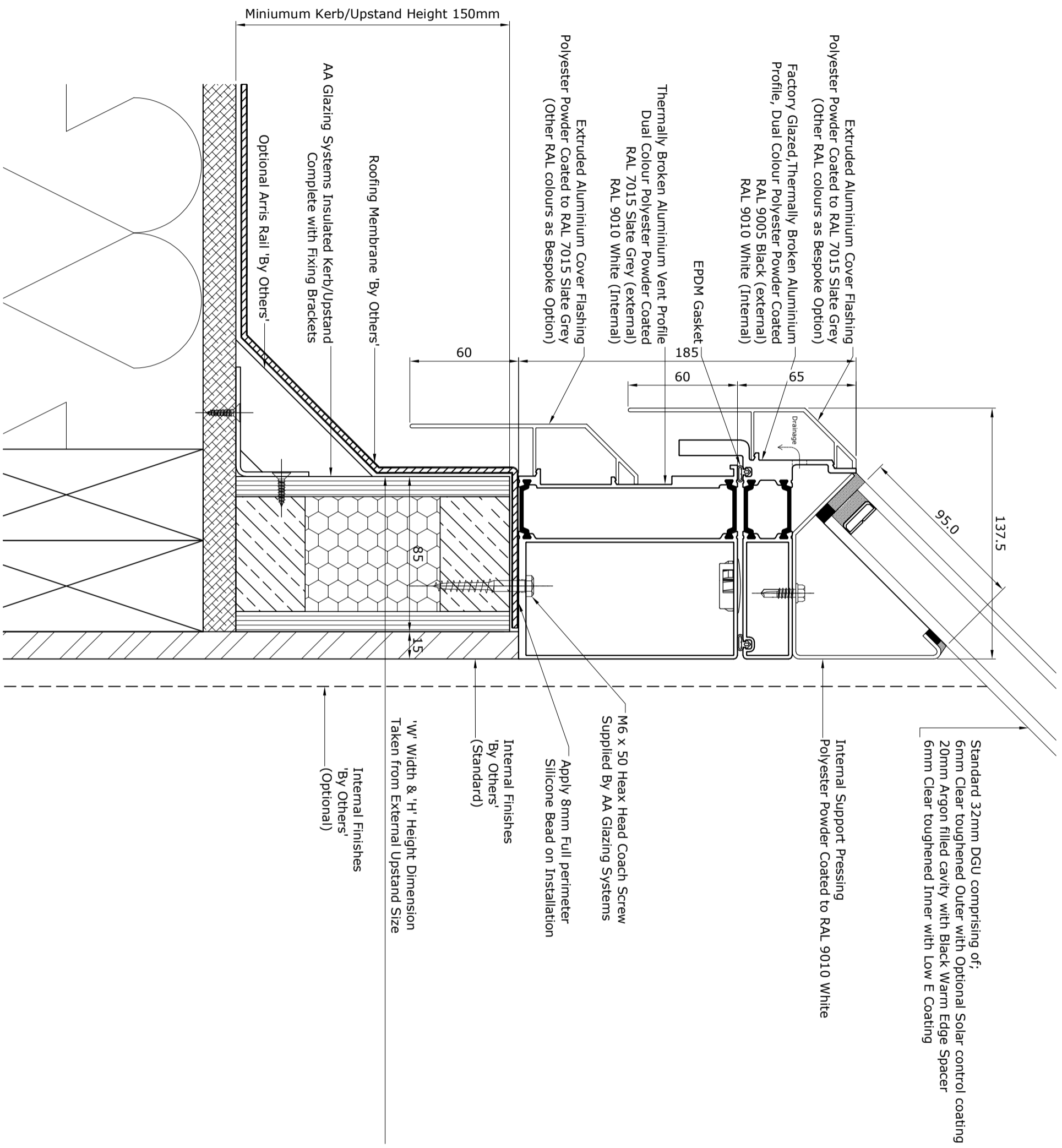

Registered Office: AA Glazing Systems Ltd, Unit Mill Lane,
Waterford Ind Est, Ct. Massingham, Norfolk, PE32 2HT
Tel: 01485-520860 Fax: 01485-520861
Email: sales@aaaglazing.co.uk
Registered in England and Wales company no. 4346652
VAT No. 792 777 488



Standard 32mm DGU comprising of;
 6mm Clear toughened Outer with Optional Solar control coating
 20mm Argon filled cavity with Black Warm Edge Spacer
 6mm Clear toughened Inner with Low E Coating

Internal Support Pressing
 Polyester Powder Coated to RAL 9010 White

M6 x 50 Heax Head Coach Screw
 Supplied By AA Glazing Systems

Apply 8mm Full perimeter
 Silicone Bead on Installation

Internal Finishes
 'By Others'
 (Standard)

'W' Width & 'H' Height Dimension
 Taken from External Upstand Size

Internal Finishes
 'By Others'
 (Optional)

Rev	Date	Int	Notes
A	23-10-13	GSH	First Issue
B	12-07-16	JW	Admin Update

Project Electric Lantern Opening Rooflight			
Title Standard Kerb / Upstand Detail			
Scale	Date	Drawn By	Status
1:2 @ A3	23-10-13	GSH	-
Contract No	Drawing No		Revision
-	VR-ELD-01		B



Registered Office: AA Glazing Systems Ltd, Unit 1 Mill Lane,
 Waterford Ind Est, Gt. Massingham, Norfolk, PE32 2HT
 Tel: 01485-520860 Fax: 01485-520861
 Email: sales@aaaglazing.co.uk
 Registered in England and Wales company no. 4346652
 VAT No. 792 777 488

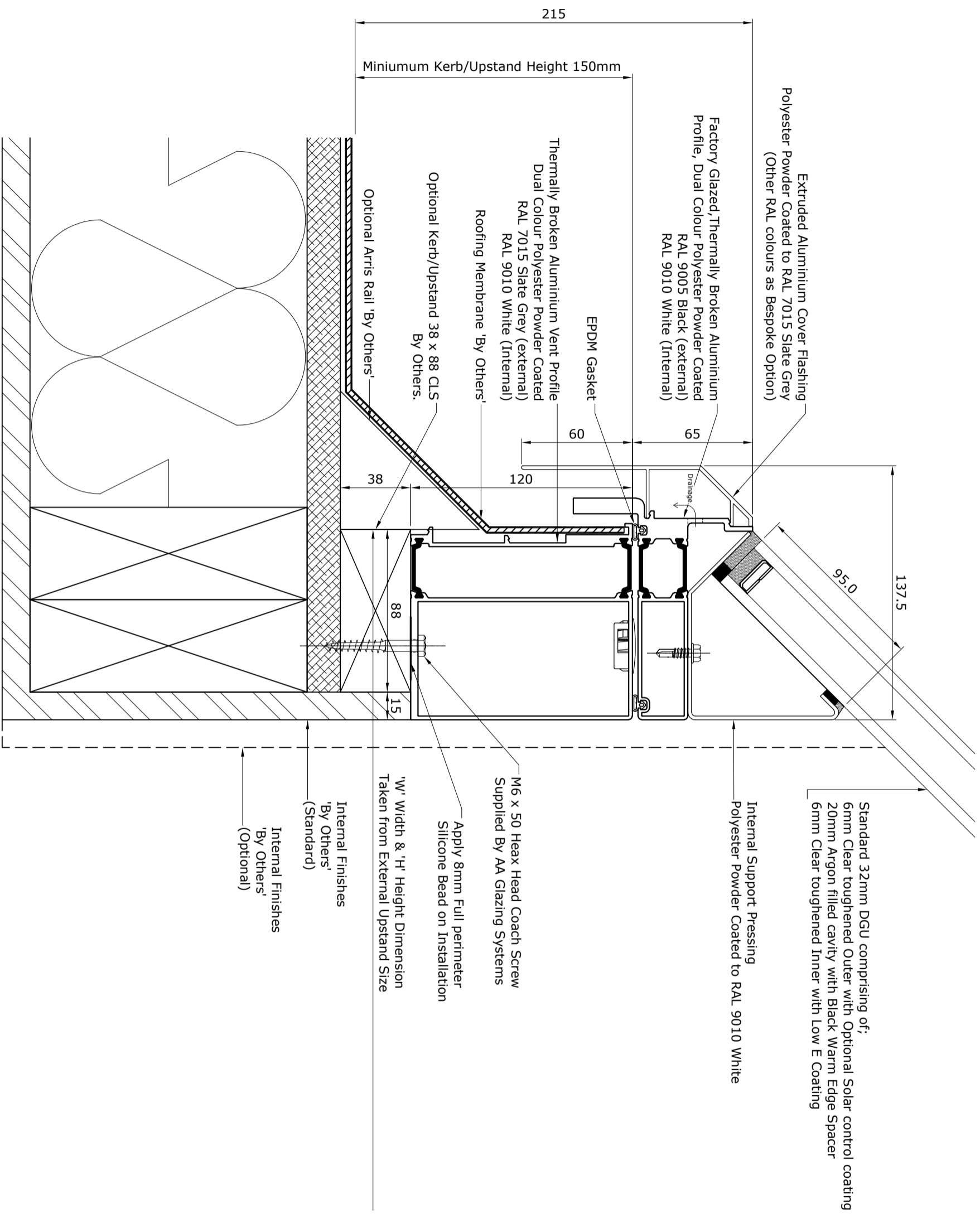

Standard 32mm DGU comprising of;
 6mm Clear toughened Outer with Optional Solar control coating
 20mm Argon filled cavity with Black Warm Edge Spacer
 6mm Clear toughened Inner with Low E Coating

Internal Support Pressing
 Polyester Powder Coated to RAL 9010 White

M6 x 50 Heax Head Coach Screw
 Supplied By AA Glazing Systems

Apply 8mm Full perimeter
 Silicone Bead on Installation

'W' Width & 'H' Height Dimension
 Taken from External Upstand Size

Internal Finishes
 'By Others'
 (Standard)

Internal Finishes
 'By Others'
 (Optional)

Project	Electric Lantern Opening Rooflight		
Title	Optional Kerb / Upstand Detail		
Scale	1:2 @ A3	Drawn By	Status
Contract No.	23-10-13	GSH	-
Contract No.	VR-ELD-02	Revision	B
Rev	Date	Int	Notes
A	23-10-13	GSH	First Issue
B	12-07-16	JW	Admin Update



Registered Office: AA Glazing Systems Ltd, Unit Mill Lane,
 Waterford Ind Est, Gt. Massingham, Norfolk, PE32 2HT
 Tel: 01485-520860 Fax: 01485-520861
 Email: sales@aaaglazing.co.uk
 Registered in England and Wales company no. 4346652
 VAT No. 792 777 488