

Project		Author	Update
Drawn		Checked	
Revised		Drawn	
Date		Issue	
Int		Notes	
Title			
Electric Access Hatch Rooflight			
Scale	1:1	Drawn By	SR
Scale @ A3	5:1	Checked	
Control No.	VR-EAD-01	Revision	B

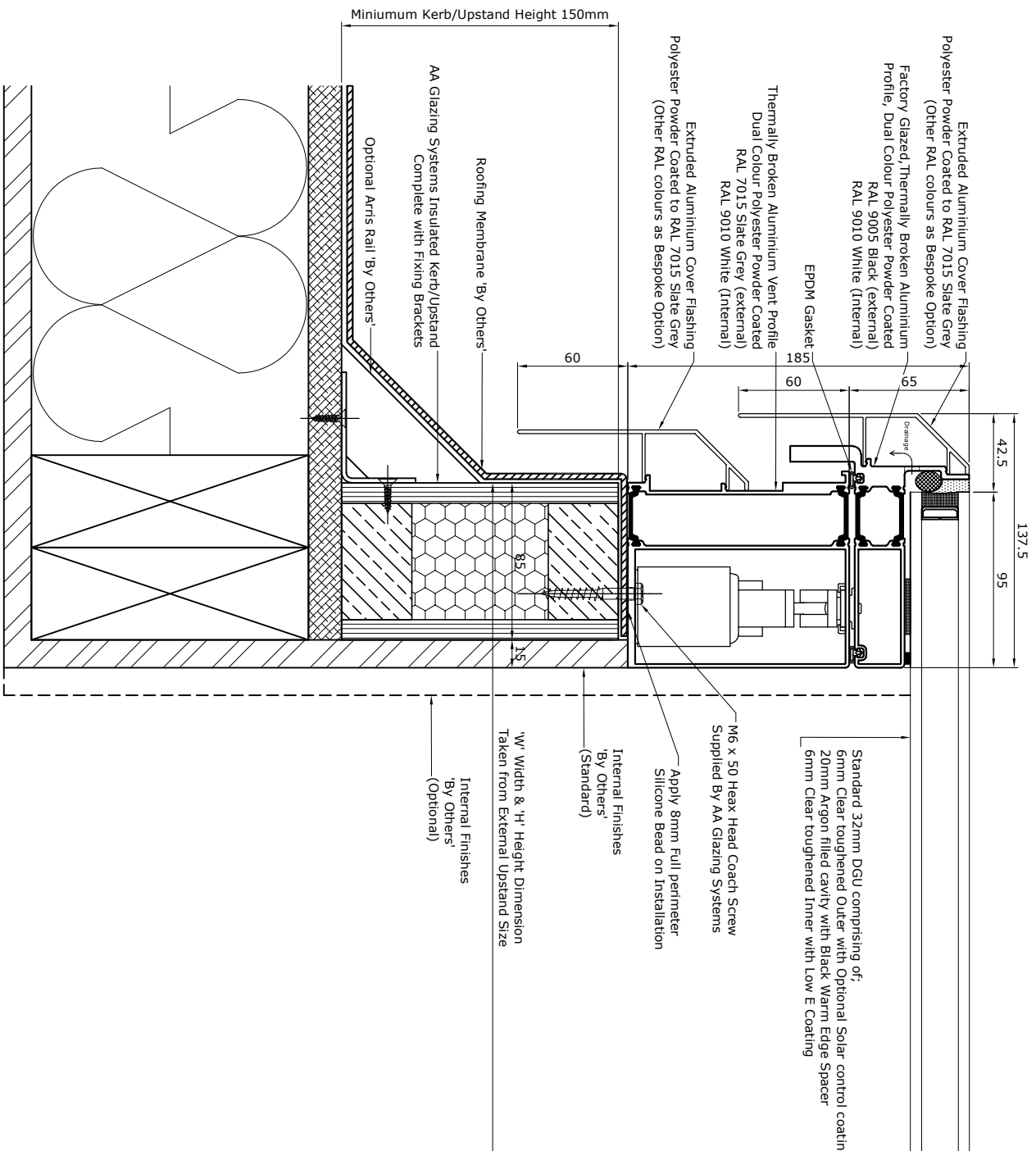

Registered Office: AA Glazing Systems Ltd, Unit Mill Lane,
Waterford Road, Castleknock, Dublin 15, Ireland
Tel: 01 856 2222
Email: sales@aa-glazing.co.uk
Registered in England and Wales company no. 4346652
VAT No. 792 777 488



Project	Electric Access Hatch Rooflight
Title	Standard Kerb / Upstand Detail
Scale	1:20 @ A3
Drawn By	VR
Checked By	VR
Contract No.	VR-EAD-01
Revision	B
Issue	Admin Update
First Issue	A
Rev. Date	Int. Int.
Rev. Issue	Notes
Rev. Date	Int. Int.
Rev. Issue	Notes
Rev. Date	Int. Int.
Rev. Issue	Notes
Rev. Date	Int. Int.
Rev. Issue	Notes
Rev. Date	Int. Int.
Rev. Issue	Notes



Registered Office: AA Glazing Systems Ltd, Unit Mill Lane,
Waterford Road, Castleisangham, Llanelli, SA41 2HT
Tel: 01449 442000
Email: sales@aa-glazing.co.uk
Registered in England and Wales company no. 4346682
VAT No. 792 777 488

